

# UM

## IMPROVED TRANSFER ARM FOR MACHINES BRANDED SIDEL S1\*



Our partners :



Covirep Sa



\*UM is not a license of Sidel nor have UM parts been approved or authorized by Sidel.

# CURRENT SITUATION

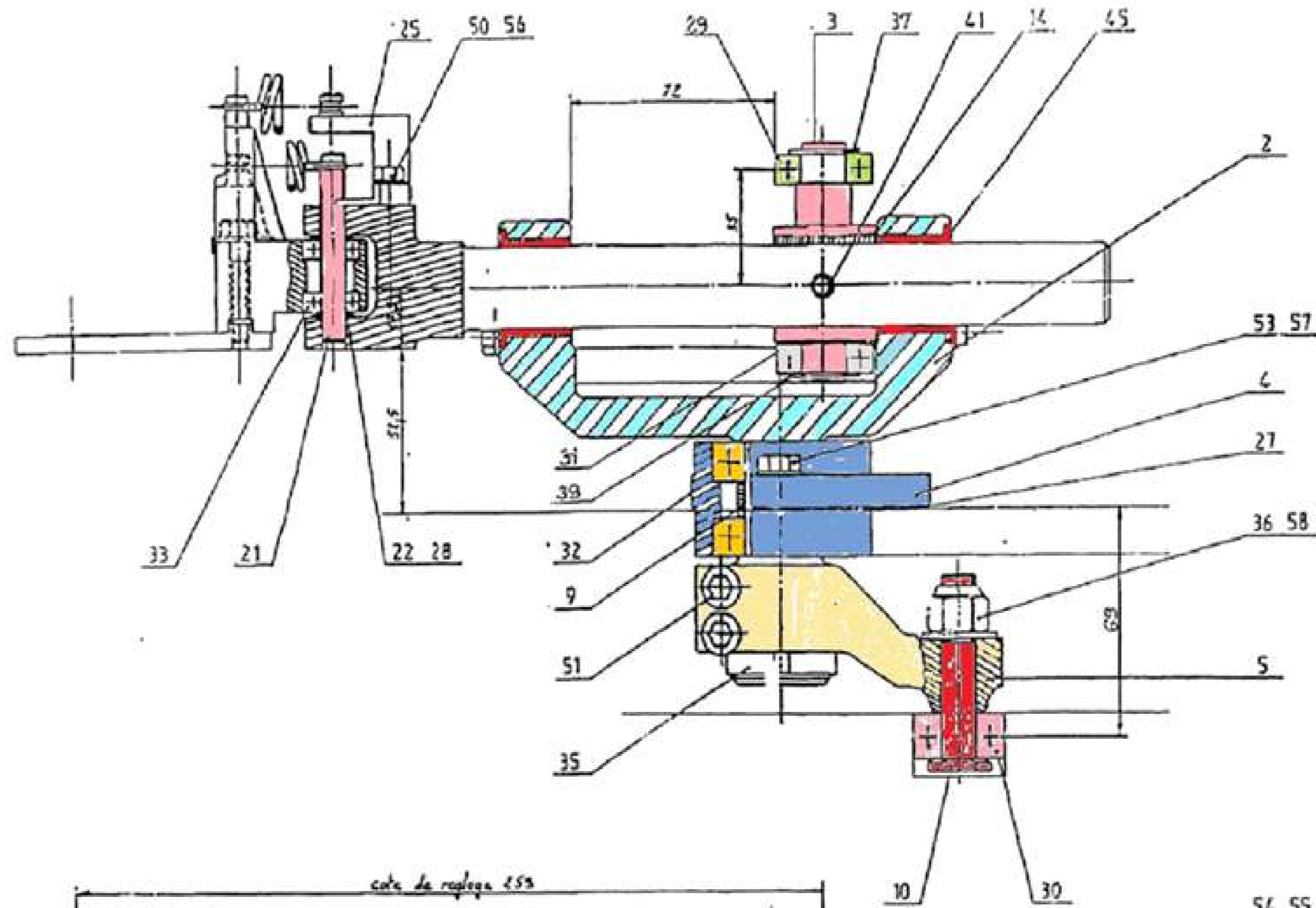

- The customer is currently using the sidel version LH645861 (1964586101).
- The customer operates a 24/26 N°2051 blower.
- After the conversion of 2 machines to a shorter neck, the transfer arms no longer seem suitable. In order to ensure good performance, 3 specific issues have been identified :

-Heads tend to get askew.

-We have measurement difference between left and right grippers.

-The arms tend to rise when returning to mussel level (end of cam, at the level of the return curve).



# PROPOSED SOLUTION

A

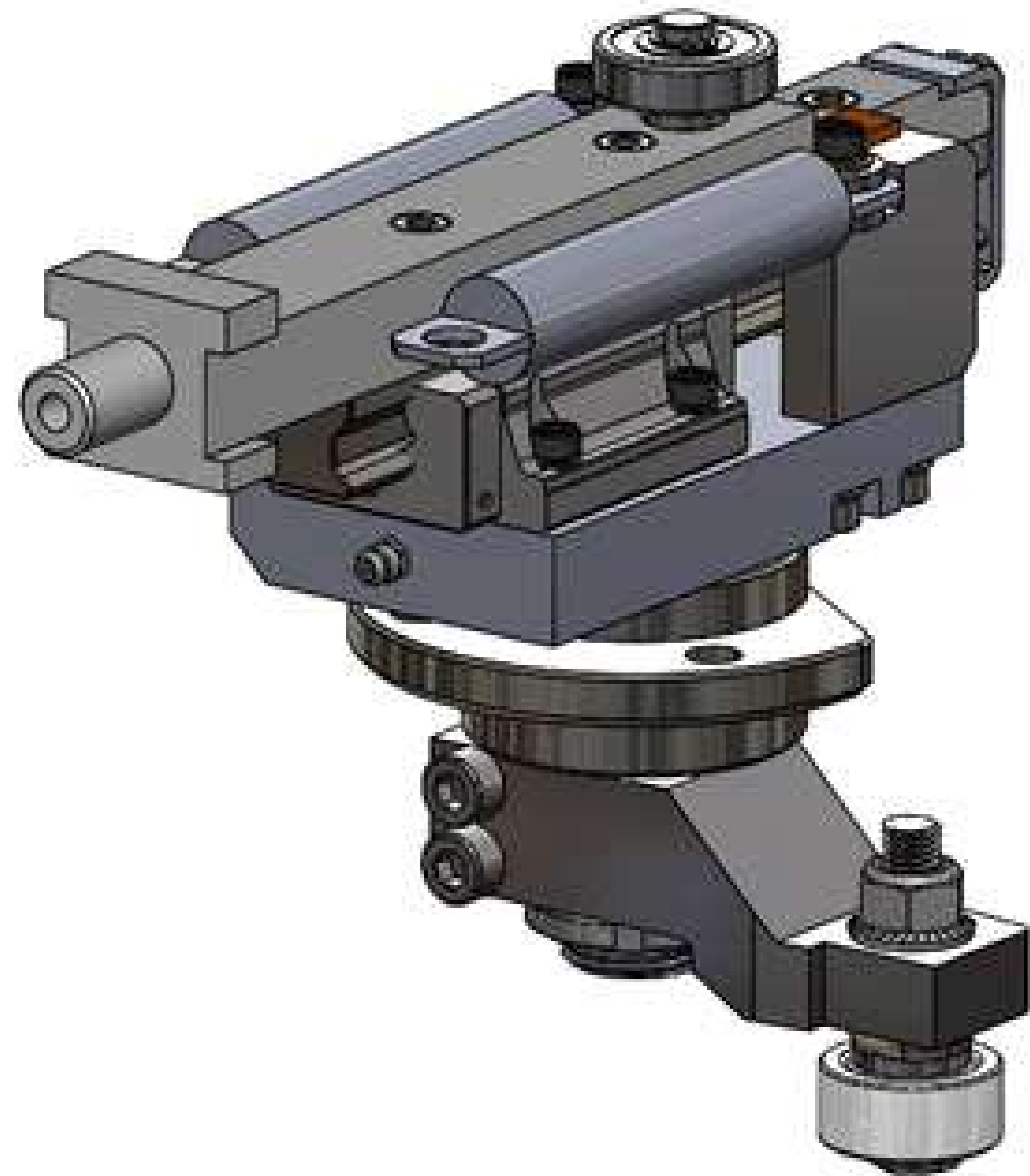

## TRANSFER ARM BODY

Improvements :

- Linear ball bearing.
- Use of a standard screw-tightening arm (image A).

or

- Use of a powerlock (image B) to improve calibration and rigidity (more expensive).
- Using an S2 transfer arm head (next page).

B

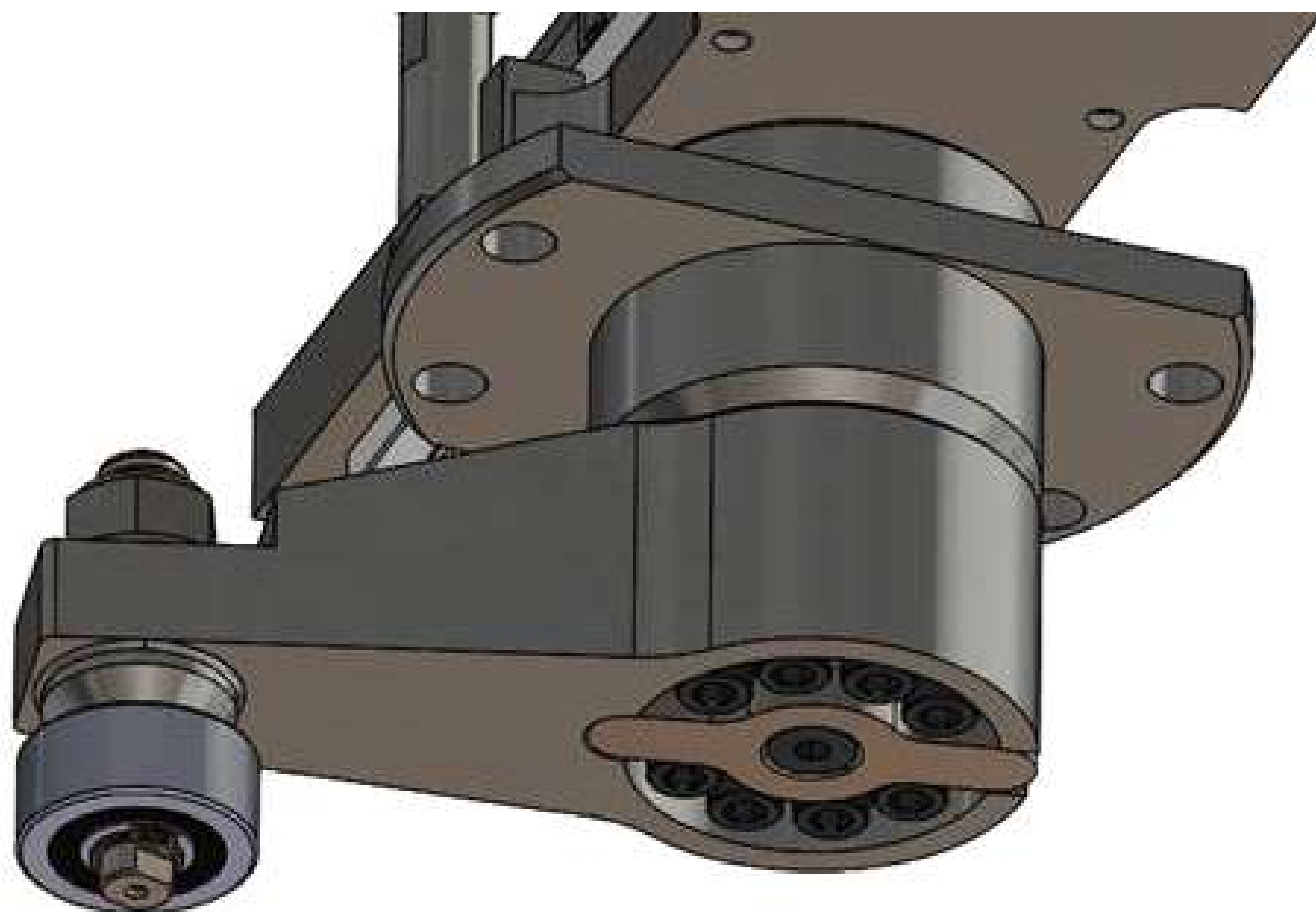

# PROPOSED SOLUTION



## TRANSFER ARM HEAD

- Use of the improved transfer arm head (lighter type Sidel S2 with ball bearing).
- May require the use of new clamps or the customization of one of the parts to join the clamps to the transfer arm head (validate the most economical solution).



# REQUIRED FOR THE PROJECT

Sending a complete transfer arm, with head and clamps, from the customer for certification/validation of the technical file (2 weeks).

Validation of the clamps type used by the customer.

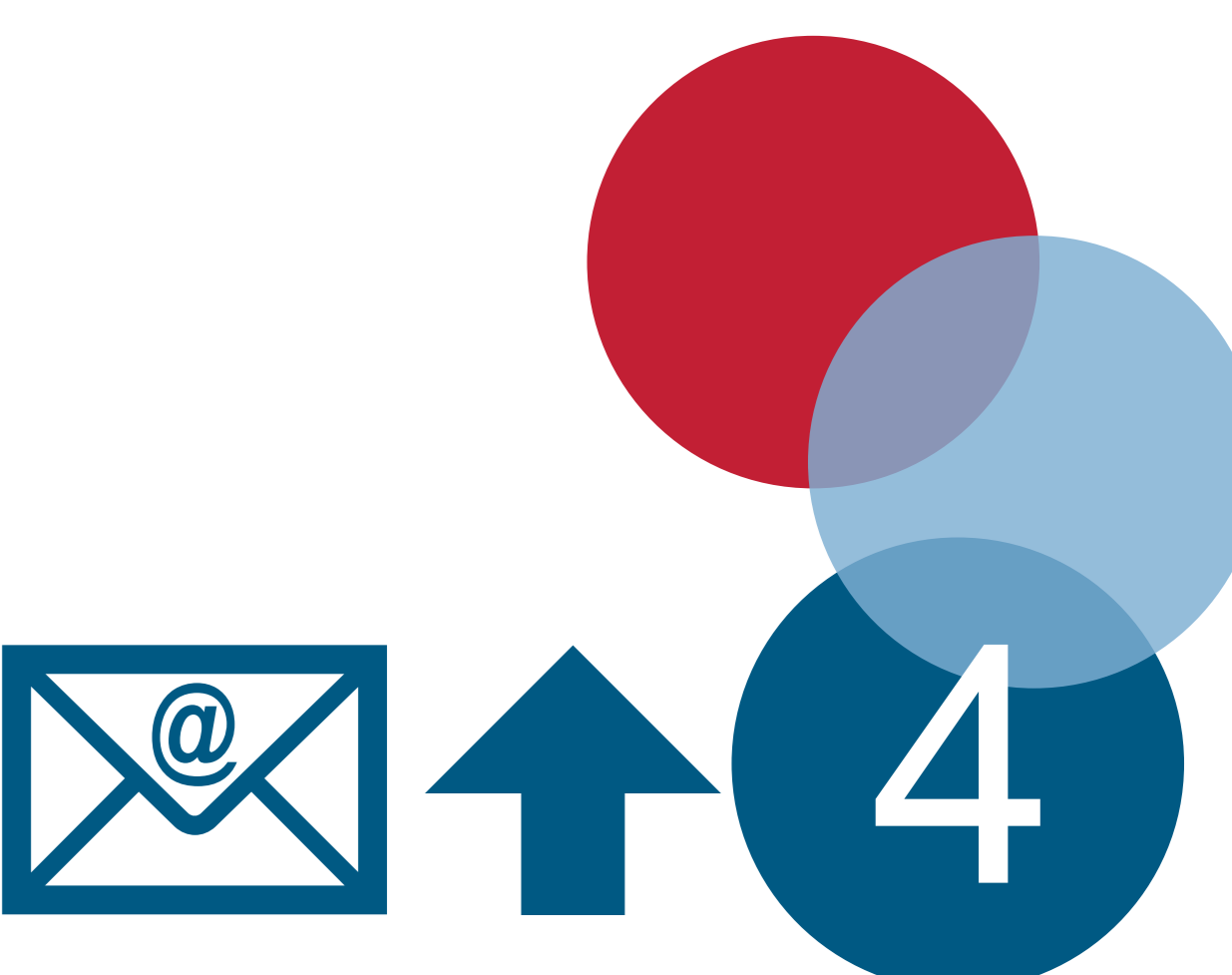

# CONTACT INFORMATION

Hubert Pelletier  
Business Development  
Associate  
+1 514-349-2493

Martin Pelletier  
Vice President  
Sales  
+1 450-454-2493 x244

[sales@umallette.com](mailto:sales@umallette.com)

[www.um-inc.com](http://www.um-inc.com)



## Our partners

